



## Baffle

Conwed Baffles bring the performance you expect from a world-class acoustic solution to the growing trend of baffles. Combined with the Conwed Express Hanging System, any space can be perfectly fitted with highly customizable baffles.

## Paint | A ▶ New Dimensions

Conwed's painted products, known as *New Dimensions*, are all uniformly sprayed using any custom color or color match in the Sherwin Williams catalog. **Products can be left unpainted** upon request to be finished in the field. Unpainted products are known as *Foundations*.

### Core construction

Dimensionally-stable 6-7 PCF fiberglass board for acoustic performance. Edges hardened for durability using resin, with connection points preinstalled. Surface is completely adhered with specially-formulated scrim, and finished with custom-paint; optionally left unpainted for finishing in the field.

1. Resin hardened edge
2. Fiberglass core
3. Scrim
4. Paint finish
5. Connection points

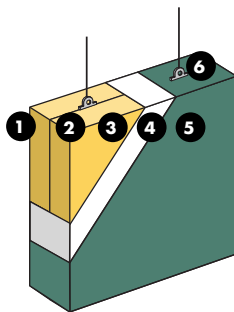

### Acoustic performance

The acoustic performance of the products are determined from an average of sound absorption coefficients, obtained from tests conducted according to ASTM C423 procedures in an NVLAP accredited laboratory.

HZ →	125	250	500	1000	2000	4000	Acoustic Performance ↓
1" thickness	—	—	—	—	—	—	—
1 ½" thickness	—	—	—	—	—	—	—
2" thickness	1.62	5.14	11.13	16.71	16.43	15.46	1.54/sqft

### Max size availabilities

Custom size is our standard

Thickness	4'x10'	4'x12'	5'x10'
1"	◦	•	•
1 ½"	•		
2"	◦	•	•

**NAF Core** No-Added-Formaldehyde core max size indicated with red dot.

**Minimum height of 6"**



Edge details	Mounting	Finish
All edges are resin hardened, unless otherwise specified.  Available choices include: • Square	Connection points preinstalled for suspension hardware.  Conwed Express Hanging System is an optional add-on.	Color-match anything to the Sherwin-Williams catalog, or leave it unpainted to be finished in the field.  All colors (except standard white) require sample approval before order fulfillment



#### Fire Rating

Conwed products meet or exceed ASTM E84 standards for smoke development and flame spread on a component level.



#### Standard Durability

This product has a durable core construction, ideal for out-of-reach areas.



#### Shapes

—



#### Connecting

—



#### Washable

Refer to the Maintenance & Cleaning Guide for more details.  
[conwed.com/cexp-maintenanceandcleaning](http://conwed.com/cexp-maintenanceandcleaning)

### Sustainability initiatives



For your LEED projects, our products can help you qualify for different points depending on the product you choose. Contact us to learn more detailed information. To view our certificate visit [conwed.com/cexp-LEED](http://conwed.com/cexp-LEED).

### Warranty

3 years. Refer to Warranty for more details.  
[conwed.com/cexp-warranty](http://conwed.com/cexp-warranty)



Disclaimer of liability: Technical information contained herein is furnished without charge or obligation and is given and accepted at recipient's sole risk. Conditions of use may vary and are beyond our control, and because of this Conwed makes no representation about, and is not responsible or liable for, the accuracy or reliability of data associated with particular uses of any product described herein.